



£1,600

## Blackpatch Grove, Shoreham-By-

- NEWLY REFURBISHED THREE BEDROOM HOUSE
- MODERN FLOOR
- NEW GREY FITTED CARPETS
- GAS CENTRAL HEATING
- NEWLY FITTED KITCHEN
- NEUTRAL DECOR THROUGHOUT
- SOUTH FACING GARDEN MAINLY LAWNED
- AVAILABLE IMMEDIATELY

ROBERT LUFF & CO are delighted to offer for rent a three bedroom mid-terraced house that has been recently redecorated by the current owners.

Comprising entrance porch leading to lounge with new modern floor, leading to dining room which also leads onto the newly fitted kitchen. There is also an under stairs cupboard and sliding patio door from dining room onto the South facing garden.

The the first floor there are three bedrooms and a family bathroom.

Early viewing recommended.

T: 01903 331247 E: [info@robertluff.co.uk](mailto:info@robertluff.co.uk)  
[www.robertluff.co.uk](http://www.robertluff.co.uk)

**Robert  
Luff & Co**  
 Sales | Lettings | Commercial





## Accommodation



30 Guildbourne Centre, Worthing, West Sussex, BN11 1LZ  
T: 01903 331247 E: [info@robertluff.co.uk](mailto:info@robertluff.co.uk)  
[www.robertluff.co.uk](http://www.robertluff.co.uk)

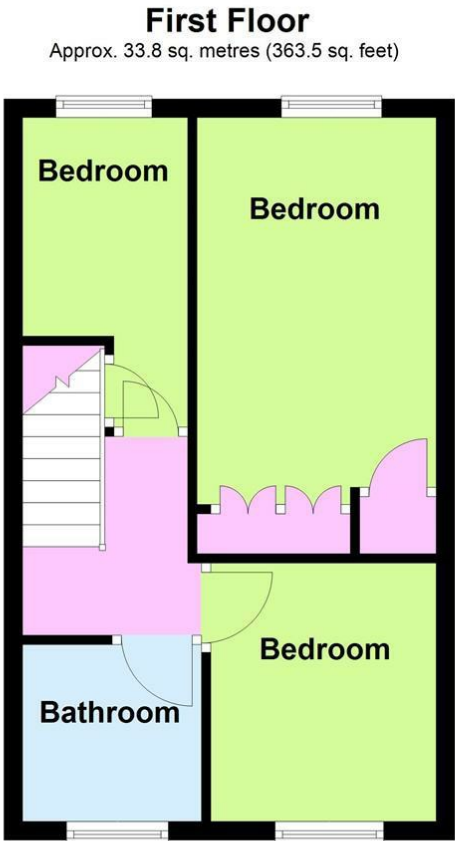

Total area: approx. 70.1 sq. metres (754.3 sq. feet)

| Energy Efficiency Rating                    |  | Current                 | Potential |
|---|--|-------------------------|-----------|
| Very energy efficient - lower running costs |  |                         |           |
| (92 plus) A                                 |  |                         |           |
| (81-91) B                                   |  |                         |           |
| (69-80) C                                   |  |                         |           |
| (55-68) D                                   |  |                         |           |
| (39-54) E                                   |  |                         |           |
| (21-38) F                                   |  |                         |           |
| (1-20) G                                    |  |                         |           |
| Not energy efficient - higher running costs |  |                         |           |
| England & Wales                             |  | EU Directive 2002/91/EC |           |

| Environmental Impact (CO <sub>2</sub> ) Rating                  |  | Current                 | Potential |
|---|--|-------------------------|-----------|
| Very environmentally friendly - lower CO <sub>2</sub> emissions |  |                         |           |
| (92 plus) A   |  |                         |           |
| (81-91) B   |  |                         |           |
| (69-80) C   |  |                         |           |
| (55-68) D   |  |                         |           |
| (39-54) E   |  |                         |           |
| (21-38) F   |  |                         |           |
| (1-20) G  |  |                         |           |
| Not environmentally friendly - higher CO <sub>2</sub> emissions |  |                         |           |
| England & Wales   |  | EU Directive 2002/91/EC |           |

The information provided about this property does not constitute or form any part of an offer or contract, nor may it be regarded as representations. All interested parties must verify accuracy and your solicitor must verify tenure/lease information, fixtures and fittings and, where the property has been extended/converted, planning/building regulation consents. All dimensions are approximate and quoted for guidance only as are floor plans which are not to scale and their accuracy cannot be confirmed. References to appliances and/or services does not imply that they are necessarily in working order or fit for the purpose.